

 **VENUE**TM
LIGHTING EFFECTS

BURST LASER
USERS MANUAL

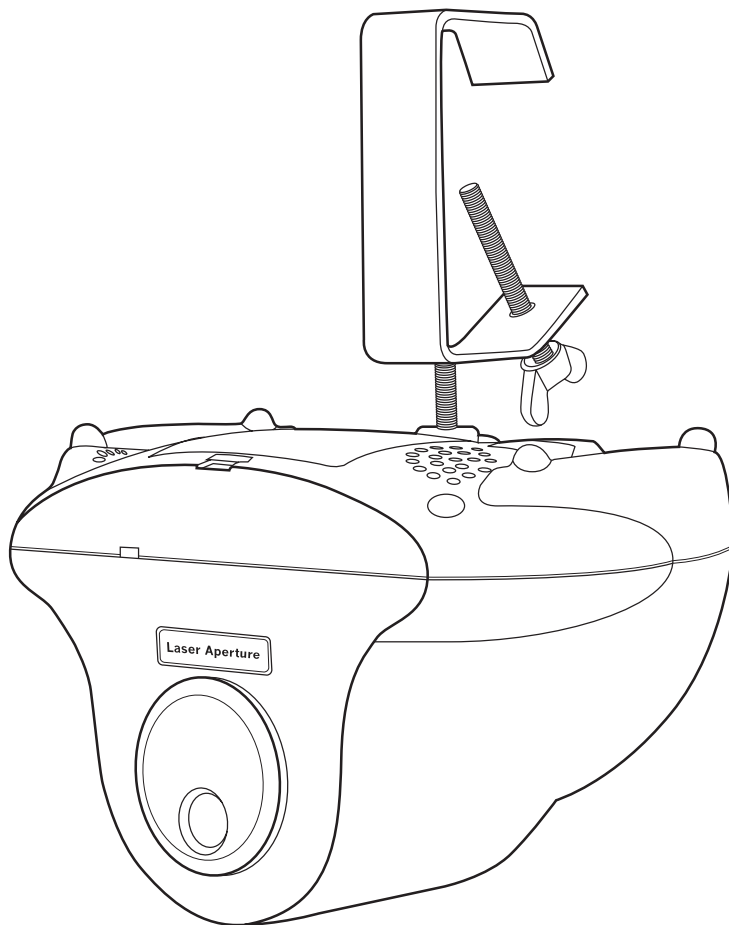

INTRODUCTION

Congratulations on your purchase of Venue's Burst Laser. Designed to operate as a simple stand-alone unit or external addition to your lighting show, the Burst Laser's key features include:

- A green diffraction gradient laser that projects sound activated patterns on your wall, floor, or ceiling
- Three operating models, with speed control
- Use with or without fog to create a stunning galaxy effect
- Seven user-interchangeable gobos
- A lightweight, compact fixture that's perfect for DJs, small clubs, and mobile use

For safe operation, read this manual before powering or installing the fixture. Be sure to follow the safety precautions listed below, and observe all warnings printed in this manual and on the fixture.

SAFETY PRECAUTIONS

- **WARNING!** Do not point this unit at the audience, as it is not to be used for audience scanning. This is a laser product — please avoid direct eye exposure.
- Do not spill liquids on or around your unit. If this does occur, disconnect the main power immediately. Do not connect this unit to any dimmer pack.
- Always disconnect the main power before making any type of connection.
- Be sure the unit is placed at least 15 cm from a wall and with adequate ventilation.
- Please unplug unit when not in use. To prevent fire or shock hazard, do not expose this unit to a high temperature/high humidity area.
- Always keep combustible materials away from the unit.
- This unit is intended for indoor use. Use of this unit outdoors voids all warranties.
- Always refer service to a qualified technician.
- Never look directly into laser beam.
- To prevent breakdowns, allow the unit to rest for extended periods of time.
- **CAUTION** – Any use other than as specified may result in radiation exposure!

SET UP

Unpacking:

Please unpack carefully to ensure all parts are still intact from shipping.

Burst Laser comes with:

- 1 C-clamp
- 1 DC power adapter
- 7 gobos
- 1 mountable base
- 1 user manual

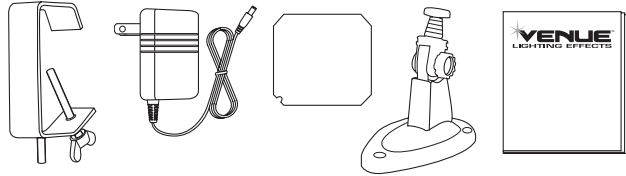

Power Connection:

Use only the included 9V DC, 300 mA, center positive power adapter or 4 AA batteries (not included).

CAUTION—Incorrect voltage selection will damage the unit.

Installation/Mounting:

Burst Laser should be properly mounted by using the included C-clamp or mountable base. Use in a well-ventilated area while making sure ventilation slots aren't blocked.

GOBO REPLACEMENT

- ① Slide the lens cover out.
- ② Remove the gobo from its holder and replace with your desired gobo.
- ③ Replace the lens cover by attaching it, while sliding it down

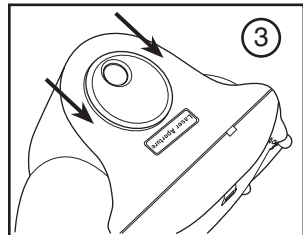
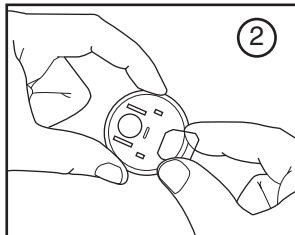
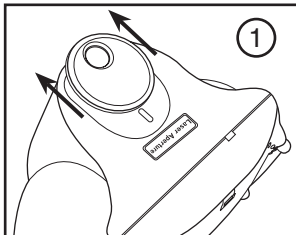

MAINTENANCE & SERVICING

No maintenance required. Work on internal parts should be performed by a qualified technician. Removal of any covers is considered a breach of warranty and will not be covered, unless first authorized by the manufacturer.

TROUBLESHOOTING

If the unit is not functioning, check to see if the power is ON and the DC jack is secure. If the unit is in audio mode, check if there is music playing. If you are still experiencing problems after trying these solutions, please contact your dealer.

SPECIFICATIONS

Product name	Green Burst Laser
Model Number	BLG
Laser	10mW
Net Weight	0.5kg (adapter and battery not included)
Power	Input 120V 60Hz 200mA Output 9V DC 600mA
Classification	2M
Battery	4 x AA (not included)
Size	L180 x W100 x H105 (bracket not included)
Housing	Plastic
Beam Divergence	>60 degrees
Operating Temp	64 – 77 degrees Fahrenheit

COMPLIANCE STATEMENT

The Burst Laser complies with FDA/CDRH 21CFR1040 and Laser Notice 50 as well as IEC 60825-1:2002. Due to its unique optic design, this product does not exceed an output beyond its classification, as this output level has been deemed appropriate for its function.

Laser Safety and Compliance Information:

This product is manufactured to comply with the IEC 60825-1 and in accordance with U.S. Food and Drug Administrations (FDA) Standards listed under FDA Document 21 CFR 1040 and subsequent laser notices.

Product Classification:

Laser Classification	Class 2M
Laser Diode	Green: 532nm / Red: 635~660nm
Cooling	Fan Cooled
Output	<20mW
Beam Points at aperture	49+
Beam Divergence	Optically adjusted for compliance
Radiant Exposure at Aperture	<1mW (7mm Human Limiting Aperture)

MANUFACTURING LABEL POSITION

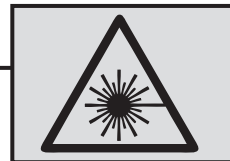
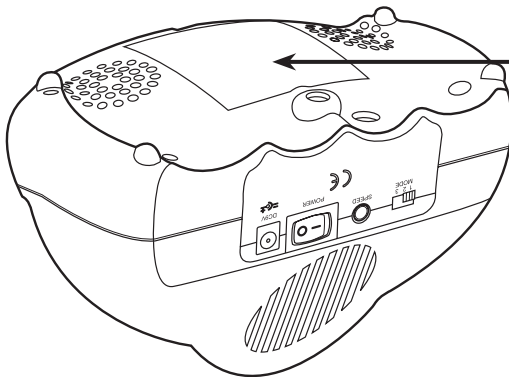

LASER RADIATION
 DO NOT STARE INTO THE BEAM OR VIEW
 DIRECTLY WITH OPTICAL INSTRUMENTS
CLASS 2M LASER PRODUCT
 <1mW max CW λ: 532/635-660nm
 IEC/EN 60825-1, ed 1.2
 This product conforms with FDA
 21 CFR 1000-1040 and subsequent
 Laser Notice 50

**CAUTION - CLASS 3B LASER
 RADIATION WHEN OPEN
 AVOID EXPOSURE TO THE BEAM**

CONTROL AND FUNCTIONS

- ① Mode Selection Switch
- ② Speed Adjustment Knob
- ③ Power Switch
- ④ External Power Supply
- ⑤ Laser Aperture
- ⑥ Internal Microphone
- ⑦ Power LED Indicator

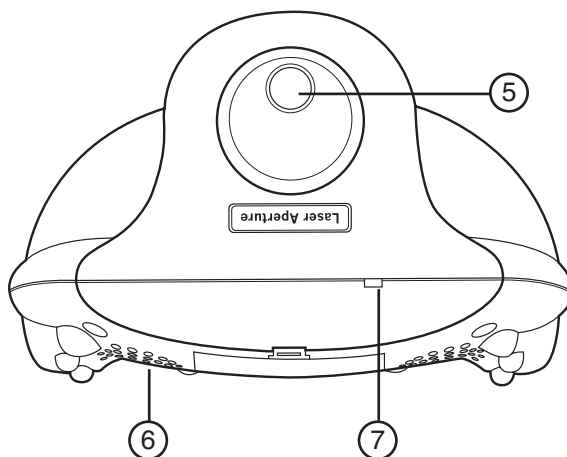
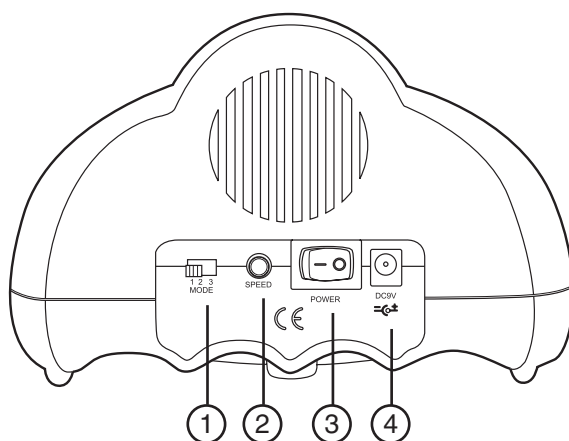

OPERATING INSTRUCTIONS

Functions:

- DC Power Input Socket – Input power: 9V DC.
- Power Switch – Used to activate and deactivate unit power.
- Speed Control Knob – Adjusts rotation speed when in Rotation Mode.
- Mode Select – Sound Active Mode 1 / Rotating Mode / Sound Active
- Mode 2 – Selectable from left to right.

Operation:

- Before plugging your unit in, make sure the source voltage in your area matches the required voltage for your Burst Laser.
- Connect the power supply to the input jack located on the rear of the Burst Laser.
- Patterns will appear after the power switch is turned ON.
- Operating modes are selected using the mode selector.
- Operating modes that can be selected are Sound Active Mode 1, Auto Mode, or Sound Active Mode 2.

Sound Active Mode 1: The unit will run to the beat of the music. When music isn't playing, the laser will not project.

Sound Active Mode 2: The unit will run to the beat of the music. However, when music isn't playing, the laser will still project.

Auto Mode: Your desired gobo pattern will project and rotate. You can control the speed of rotation using the speed control knob located to the right of the mode selector switch.

For safety reasons, please turn off the power after using the unit by unplugging the power supply from the power outlet.

One (1) Year Limited Warranty

Subject to the limitations set forth below, Venue™ hereby represents and warrants that the components of this product shall be free from defects in workmanship and materials, including implied warranties of merchantability or fitness for a particular purpose, subject to normal use and service, for one (1) year (ninety (90) days on lamps) to the original owner from the date of purchase.

Retailer and manufacturer shall not be liable for damages based upon inconvenience, loss of use of product, loss of time, interrupted operation or commercial loss or any other incidental or consequential damages including but not limited to lost profits, downtime, goodwill, damage to or replacement of equipment and property, and any costs of recovering, reprogramming, or reproducing any program or data stored in equipment that is used with Venue™ products. This guarantee gives you specific legal rights. You may have other legal rights which vary from state to state. Some states do not allow limitations on how long an implied warranty lasts, so the above limitation may not apply to you.

California Prop 65 Warning

This product may contain a chemical(s) known to the state of California to cause cancer or birth defects or other reproductive harm.

Venue Lighting Effects

P.O. Box 5111

Thousand Oaks, CA 91359-5111

www.venuelightingeffects.com

All trademarks and registered trademarks mentioned herein are recognized as the property of their respective holders.

Made in Taiwan

0905-8982



www.venuelightingeffects.com